

Check Valve

1/2" up to 2"

4000



Non-return valve for backflow prevention

- All wetted parts stainless steel
- Compact design
- Sealing material PTFE



Technical Information

Nominal sizes	1/2" - 2"
Body material	Stainless steel 316 L
Material inner parts	Stainless steel 316 Ti
Material seating seal	Teflon (PTFE)
Connections	NPT-thread 1/2" - 2" (welding ends on request)
Pressure class	580 psi
Maximum differential pressure (back pressure)	235 psi (higher on request)
cracking/lifting pressure	3 psi
Temperature range	-5°F to +390°F

Dimensions and Weights

DN	A Rp	H	D	S	Lg	LS	SW1	SW2	Cv value	Weight lbs	Ordering number
15	NPT 1/2"	1,69	0,84	0,08	2,56	3,15	1,06	0,98	3,02	0,55	4051500
20	NPT 3/4"	2,13	1,06	0,09	2,95	3,54	1,26	1,22	6,96	0,93	4051501
25	NPT 1"	2,54	1,33	0,10	3,54	3,94	1,61	1,54	13,34	1,43	4051502
32	NPT 1 1/4"	3,11	1,67	0,10	4,33	4,33	1,97	1,89	21,46	2,43	4051503
40	NPT 1 1/2"	3,54	1,90	0,10	4,72	4,72	2,36	2,17	32,48	3,31	4051504
50	NPT 2"	4,06	2,37	0,11	5,91	5,91	2,36	2,68	47,56	4,85	4051505

Dimension in inch

Body with threaded ends

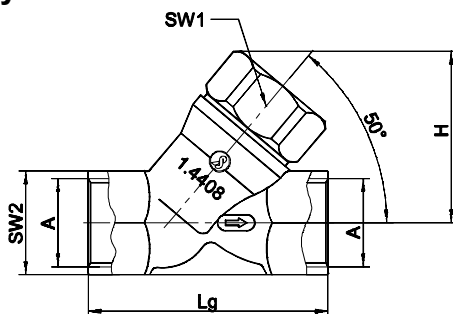

Body with welded ends

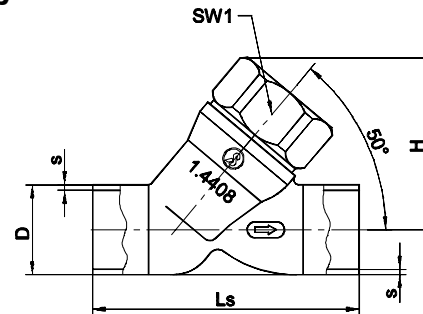

Line Strainer 4005

Dimensions and Weights

DN	A Rp/NPT	C	H	D		S		Lg	Ls	SW1	SW2	Cv value	Weight lbf
				DIN	ISO	DIN	ISO						
1/2"	1/2"	0.59	1.59	0.71	0.84	0.06	0.08	2.56	3.15	1.06	0.98	2.9	0.5
3/4"	3/4"	0.64	1.89	0.87	1.06	0.06	0.09	2.95	3.54	1.26	1.22	5.8	0.5
1"	1"	0.75	2.26	1.1	1.33	0.06	0.1	3.54	3.94	1.61	1.54	9.9	1
1 1/4"	1 1/4"	0.84	2.78	1.34	1.67	0.06	0.1	4.33	4.33	1.97	1.89	16.8	2
1 1/2"	1 1/2"	0.84	2.87	1.57	1.9	0.06	0.1	4.72	4.72	1.97	2.17	22.6	2.5
2"	2"	1.01	3.48	2.05	2.37	0.06	0.11	5.91	5.91	2.36	2.68	34.8	3.5
2 1/2"	2 1/2"	1.19	4.37	2.76	3	0.08	0.11	7.09	7.09	2.95	3.35	60.3	7.5

Dimension in inch

Body with threaded ends

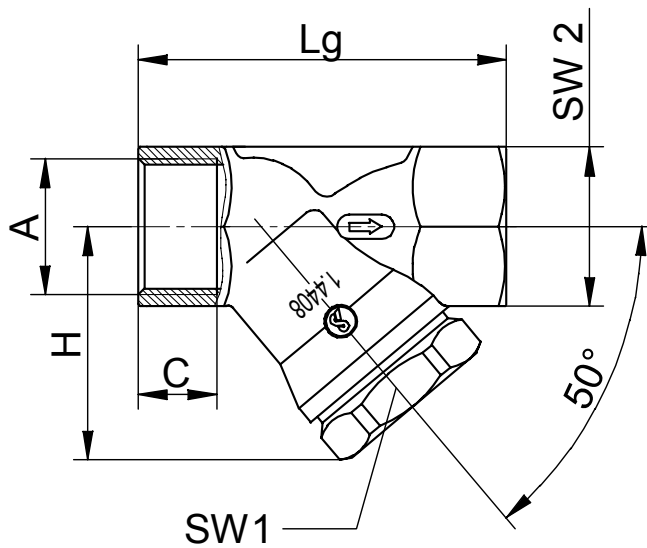

Body with welded ends

